

Centratori prismatici / Straight block set

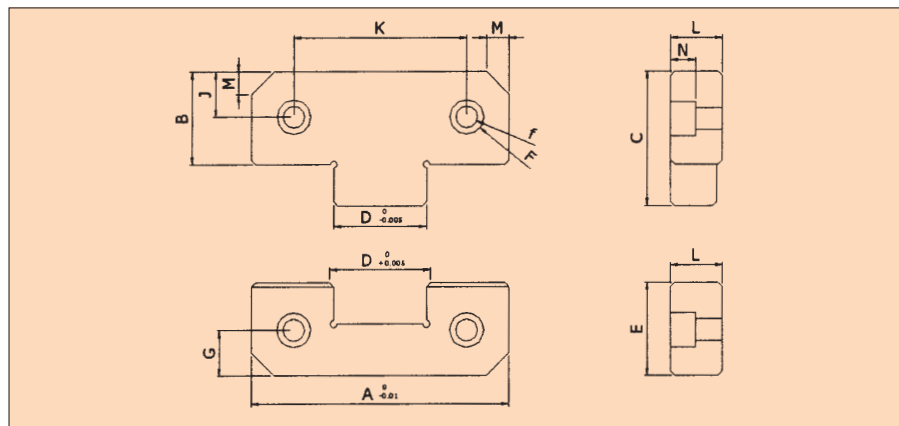

Materiali: Wr. nr. 1.3514 (56-60 HRC) o Wr. nr. 1.2379 (58-62 HRC)

| Codice mm. | A | B | C | D | E | F | f | G | J | K | L | M | N |
|------------|-----|------|----|----|------|------|------|----|----|----|----|----|----|
| GPL38 | 38 | 22 | 30 | 12 | 22 | 10.5 | 6.5 | 7 | 7 | 22 | 13 | 5 | 8 |
| GPL50 | 50 | 21.5 | 30 | 17 | 21.5 | 10.5 | 6.5 | 11 | 11 | 34 | 16 | 5 | 8 |
| GLP75 | 75 | 36 | 50 | 25 | 36 | 16.5 | 10.5 | 18 | 15 | 50 | 19 | 8 | 12 |
| GPL100 | 100 | 45 | 65 | 35 | 45 | 16.5 | 10.5 | 22 | 22 | 70 | 19 | 10 | 12 |
| GPL125 | 125 | 45 | 65 | 45 | 45 | 16.5 | 10.5 | 22 | 22 | 84 | 25 | 10 | 12 |

Esempio di ordinativo: GPL...