

Bussole di foratura corte e lunghe / Long and short piercing bushes

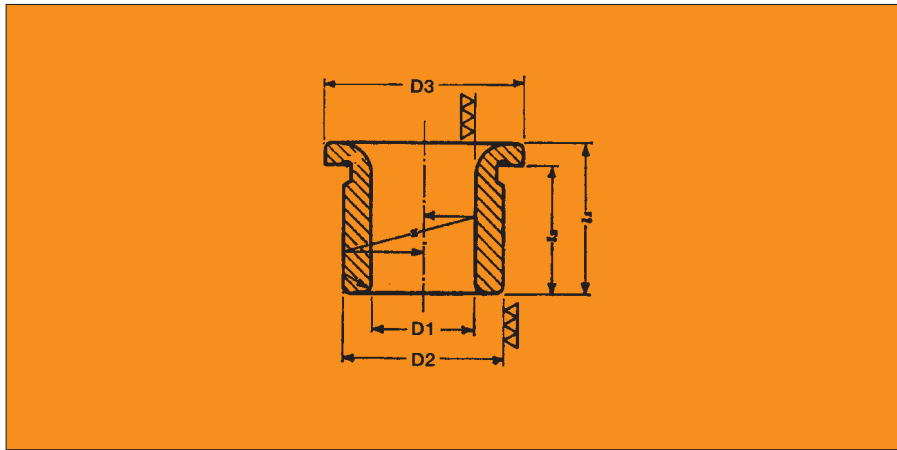

DIN 172



Tolleranze: F7 per \varnothing D1 - n6 per \varnothing D2
Tolerances: F7 for \varnothing D1- n6 for \varnothing D2

Durezza: HRC 60 ÷ 62
Hardness HRC 60 ÷ 62

Esecuzione: Temperate, rinvenute, rettificate
Execution: Hardened, tempered, grinded

D1	D2	D3	172 Corte / Short			172 Lunghe / Long		
			L1	L2		L1	L2	
2 - 2,6	5	8	6	4	—	9	7	—
2,7 - 3,3	6	9	8	6	—	12	9	—
3,4 - 4,0	7	10	8	6	—	12	9	—
4,1 - 5,0	8	11	8	6	—	12	9	—
5,1 - 6,0	10	13	10	7	—	16	13	—
6,1 - 8,0	12	15	10	7	—	16	13	—
8,1 - 10	15	18	12	9	—	20	17	—
10,1 - 12	18	22	12	8	—	20	16	—
12,1 - 15	22	26	16	12	—	28	24	—
15,25 - 18	26	30	16	12	—	28	24	—
18,25 - 22	30	34	20	15	—	36	31	—
22,25 - 26	35	39	20	15	—	36	31	—
26,25 - 30	42	46	20 25	15 20	— —	36 45	31 40	— —
30,25 - 35	48	52	25	20	—	45	40	—
35,5 - 42	55	59	25 30	20 25	— —	45 56	40 51	— —
42,5 - 48	62	66	30	24	—	56	50	—
48,5 - 55	70	74	30	24	—	56	50	—
56 - 62	78	82	35	29	—	72 67	66 61	— —

Esempio di ordinativo: D1 x Lunghe / Corte

Normali e di alta qualità
Normal and high quality type

